

MicroCoat MC800 Setup Guide

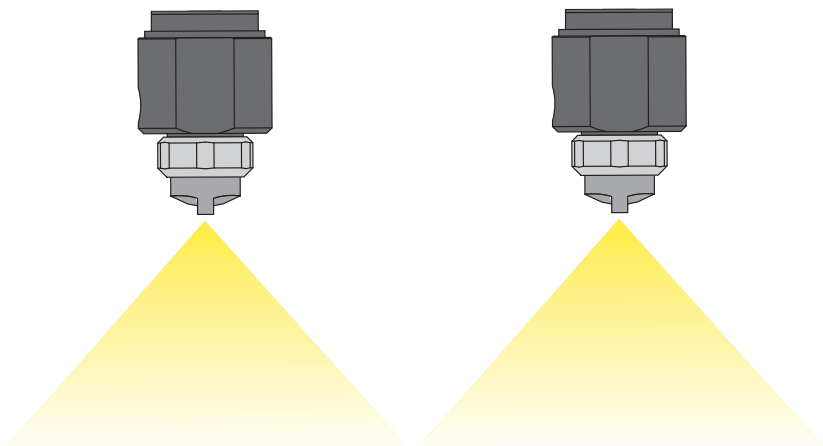

Configure your MC800 MicroCoat® system with tank, stand, and control solenoid.

Sales and service of the MicroCoat System are available worldwide through Nordson EFD authorized distributors.

For detailed operating instructions and safety guidelines, please refer to your MicroCoat System Operating Manual.

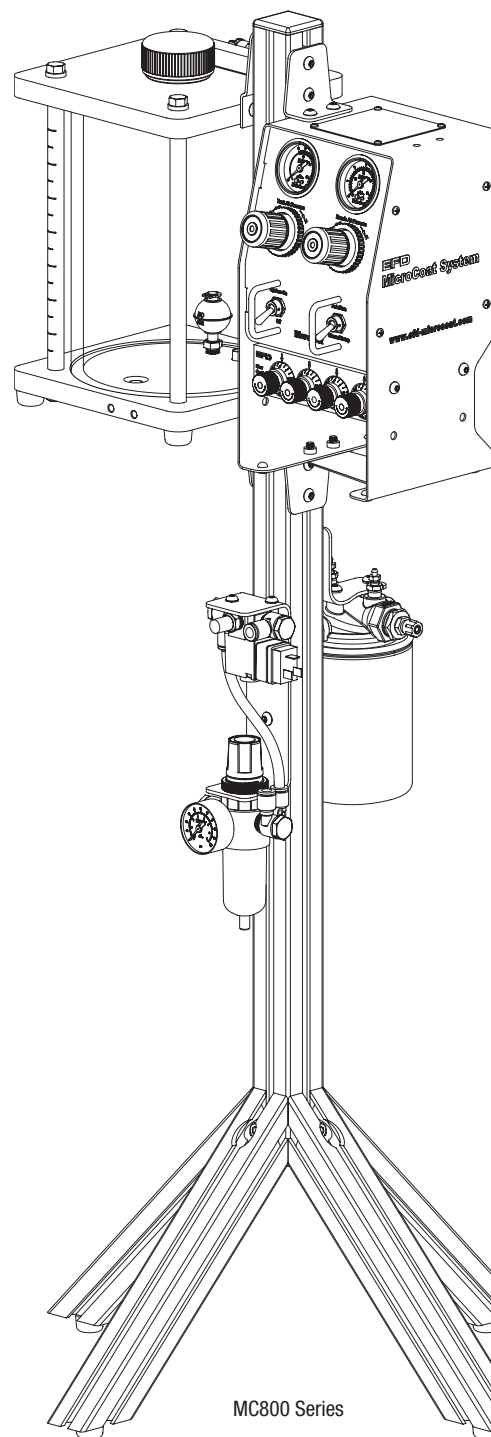

⚠ ATTENTION

Confirm settings.

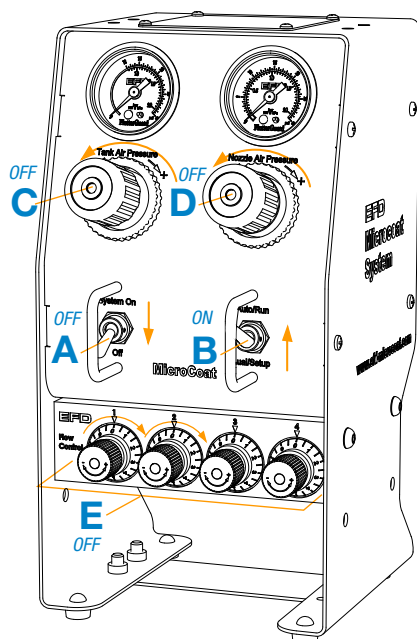

- A.** System: **OFF**
- B.** Auto/Run: **ON**
- C.** Tank Air Pressure: **OFF**
- D.** Nozzle Air Pressure: **OFF**
- E.** All Flow Controls: **OFF**

MC800 Series

1. Connect air filter regulator. Set to 4.14 bar (60 psi).
2. Connect air solenoid to press run / clutch circuit.
3. Mount valves and manifolds. Connect color-coded hoses between controller, manifolds, and valves.
4. Do the following:
 - A. Connect reservoir and filter fluid lines to flow control inlet fitting.
 - B. Connect reservoir pressure hose to tank air outlet on controller.
 - C. Fill reservoir.
5. Connect in series with press Emergency Stop circuit.

Note: Review steps 2 & 6 with plant electrician.

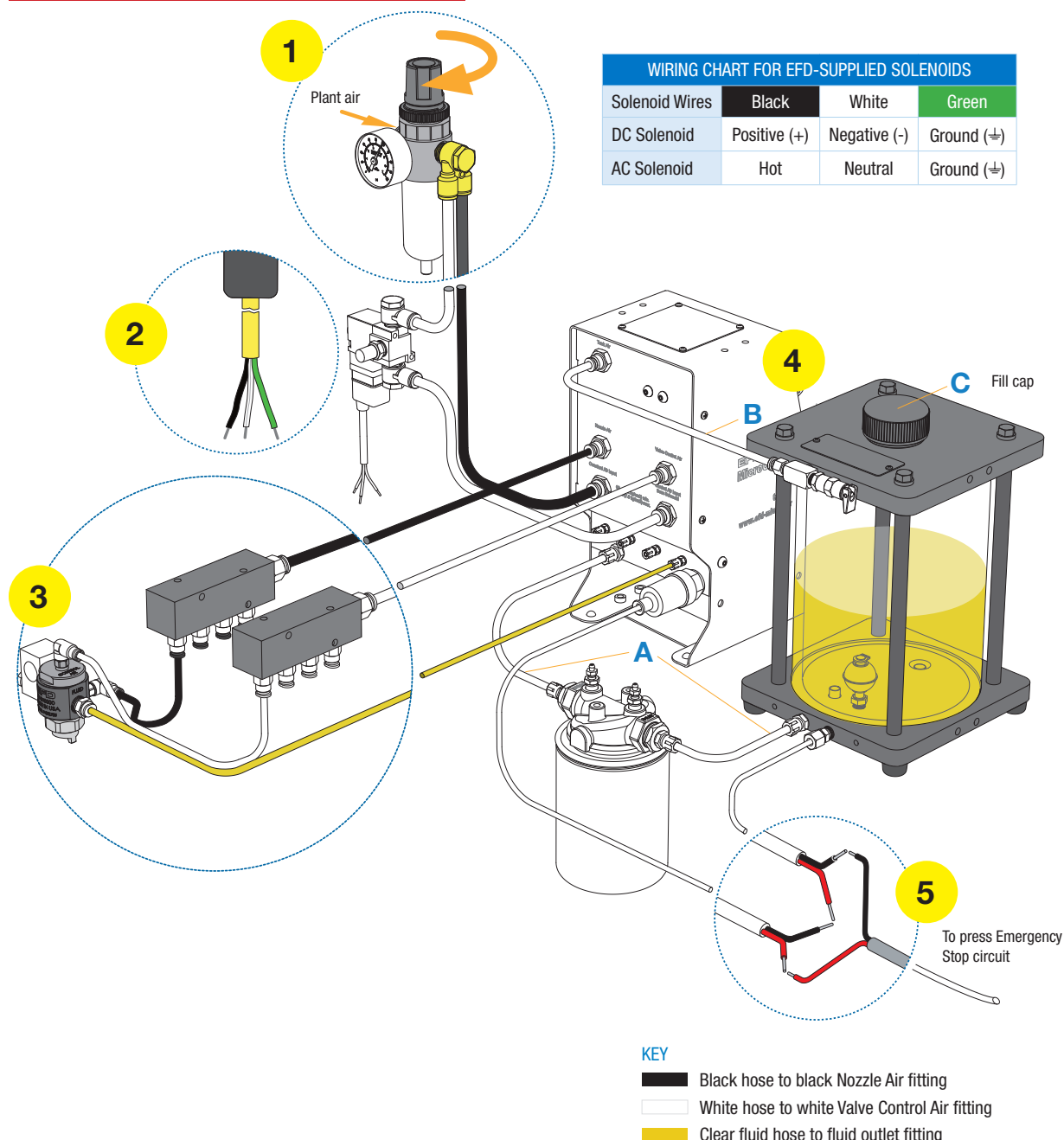

6. Do the following:
 - A. **System ON**
 - B. **Tank Air Pressure** to 1.04 bar (15 psi)
 - C. Auto/Run to **Manual/Setup**
7. Clear the air from the lubricant filter. Insert tube into bleed valves. Open bleed valves one at a time 1/2 turn. Once fluid flows from the bleed valves, close. Prime each valve.
8. Prime each valve.
 - A. Open each **Flow Control** five (5) full turns. When lubricant flows without any trace of air, close all **Flow Controls**.
 - B. Adjust **Flow Controls** so lubricant flows at about one drop per second. Use this setting as a starting point for all valves.
 - C. Turn **Nozzle Air** until pressure reads 0.69 bar (10 psi). Higher pressure provides finer spray. Too much pressure causes fogging.
 - D. SWITCH to **Auto/Run**. The valves stop spraying and the **Nozzle Air** pressure drops to 0 bar (0 psi).

The system is ready.

When press is on, **Nozzle Air** pressure will return to 0.69 bar (10 psi), and valves will spray. Check lubricant coverage and make adjustments as necessary.

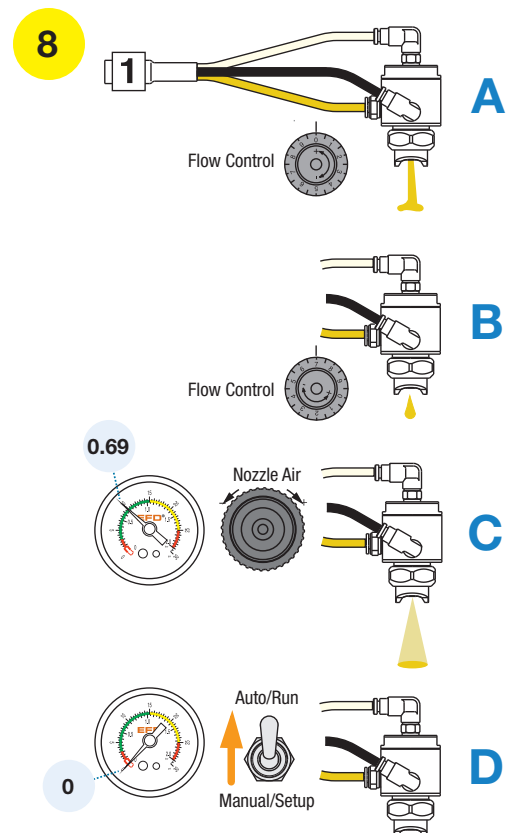
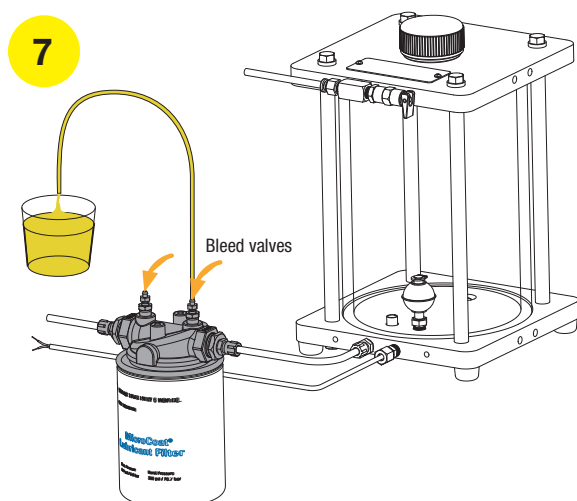
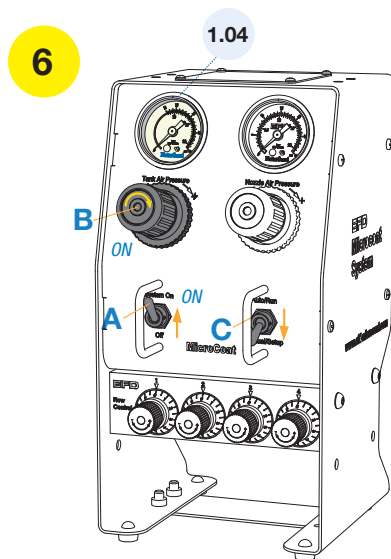

Accessories

For all available accessories, refer to the MicroCoat Lubrication System Parts & Accessories List:

www.nordsonefd.com/MC800PartsAccessories



For Nordson EFD sales and service in over 40 countries, contact Nordson EFD or go to www.nordsonefd.com.

Global

800-556-3484; +1-401-431-7000
info@nordsonefd.com

Europe

00800 7001 7001
infoefd.europe@nordsonefd.com

Asia

China: +86 (21) 3866 9006; china@nordsonefd.com
India: +91 80 4021 3600; india@nordsonefd.com
Japan: +81 03 5762 2760; japan@nordsonefd.com
Korea: +82-31-736-8321; korea@nordsonefd.com
SEAsia: +65 6796 9522; sin-mal@nordsonefd.com