

# EPC™ Deckle Die Replacement Parts

Suggested Items to Stock



| Part   | Suggested Qty                  |
|--|--------------------------------|
|  | Percentage of Total Qty Needed |
| <input type="checkbox"/> End Seal Gaskets<br><i>Note: For EPC dies there are 4 gaskets in each set, 2 for each end</i> | Minimum of 4 sets              |
| <input type="checkbox"/> Brass End Plate Seal Gasket   | 2 sets                         |
| <input type="checkbox"/> Deckle Rods<br><i>Note: 2 rods in each set</i>  | 3 sets                         |
| <input type="checkbox"/> End Seal Packing Plate Bolts & Washers  | 100%                           |
| <input type="checkbox"/> Deckle Mounting Bolts   | 100%                           |
| <input type="checkbox"/> Solid Seal Bar (if you have this style)<br><i>Note: 1 set = 2 bars, 1 for each end</i>        | 1 Set                          |
| <input type="checkbox"/> Split Seal Bar with Lip Shims (If you have this style)  | 1 Set                          |
| <input type="checkbox"/> Lip Shims for the Split Seal Bar (If you have this style)                                     | 3 Sets                         |
| <input type="checkbox"/> Split Seal Bar Mounting SHCS (If you have this style)   | 100%                           |
| <input type="checkbox"/> Seal Bar Dowel Pins (For both types of seal bars)   | Minimum of 3                   |

To order EPC Deckle die replacement parts, please contact us at [spareparts@nordson.com](mailto:spareparts@nordson.com).

# EPC™ Deckle Die Replacement Parts

Suggested Items to Stock

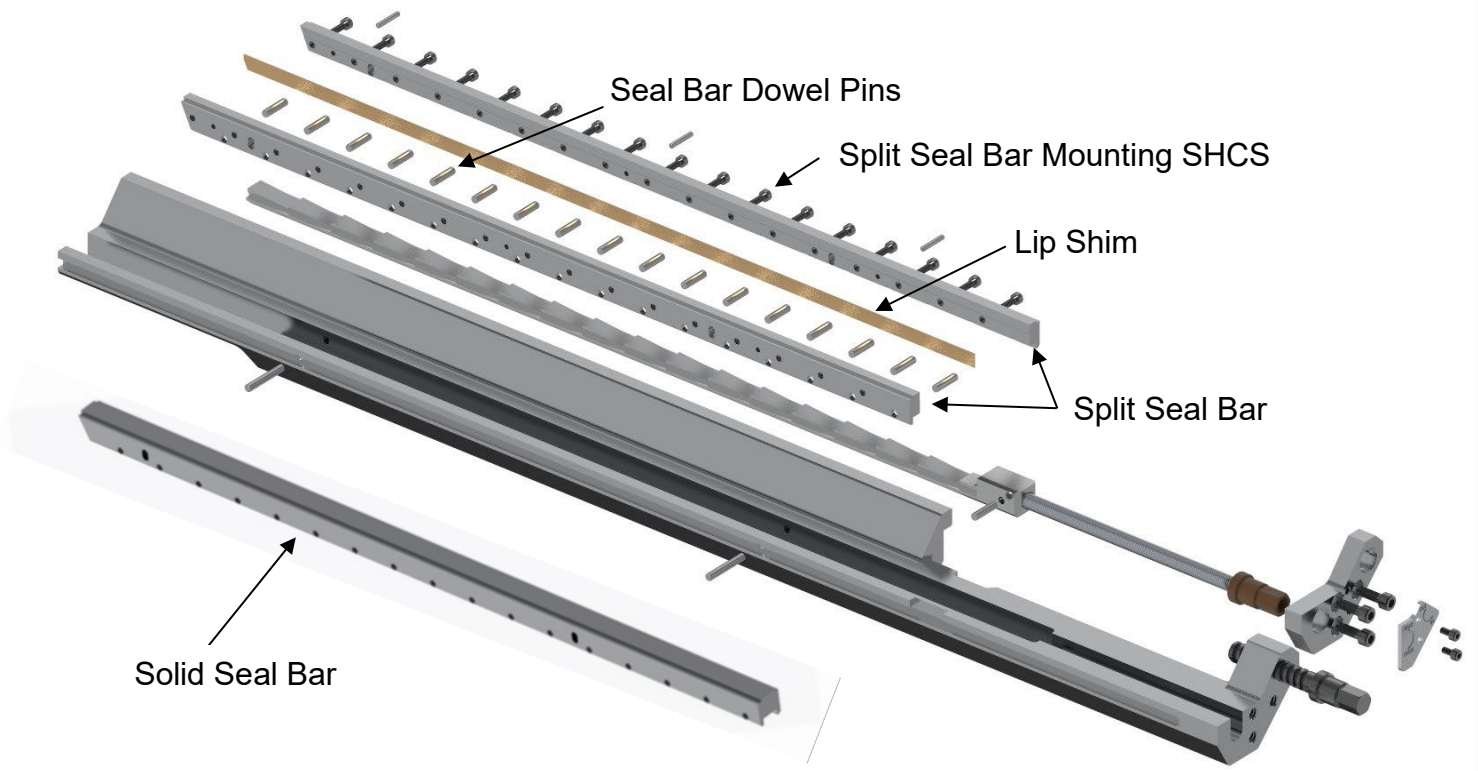
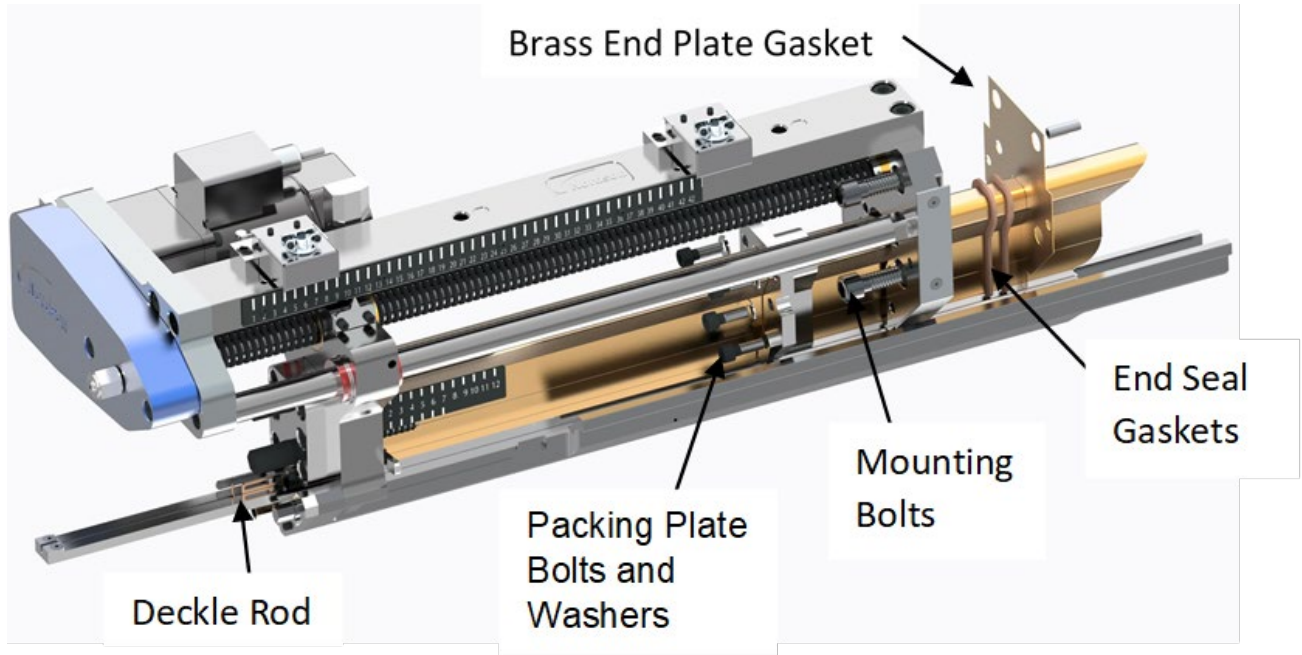

**Nordson Extrusion Dies Industries, LLC**  
1450 Lakeland Drive  
Chippewa Falls, WI 54729 USA  
+1.715.726.1201 Phone

**China**  
+86.21.57850918 Phone

**Germany**  
+49.251.26501.0 Phone

**Japan**  
+81.3.5762.2770 Phone

[www.nordsonpolymerprocessing.com](http://www.nordsonpolymerprocessing.com) | [info@nordsonpolymerprocessing.com](mailto:info@nordsonpolymerprocessing.com)

05/2020

