

Reliable Powder Coating Guns for Automated Applications

Designed for use with the Nordson automatic powder coating systems, the Encore automatic gun is one of the most reliable powder application tools in the industry. With 100 kV electrostatic capacity, ultra-fast nozzle retention, robust mounting features, and optimized air-purge cleanability, it provides the highest transfer efficiency, quickest color change times, and easiest maintenance available.

Operator Selectable Electrostatic Modes and Control for Superior Performance

Precise control of gun electrostatics is critical to ensure optimal powder charge and subsequently the overall quality and efficiency of any powder coating operation. The Encore automatic gun comes standard with the unique combination of Automatic Feedback Current (AFC) and Select Charge technology to provide the flexibility and control required to tackle the toughest coating applications.

When AFC mode is activated, the controller automatically adjusts electrostatic voltage output to maintain the optimal powder charge and external field strength, regardless of the gun-to-part distance. This is especially important to ensure uniform powder thickness when parts are swinging or gun-to-part distance varies due to high product mix. Select Charge Technology changes the electrostatic load curves to reduce faraday effect and back ionization when coating various types of products. Multiple options are available to choose from to help take the guess work out of settings development.

Encore's Digital Powder Flow Control

Typically, powder flow and atomizing air settings are determined, which controls the amount of powder exiting the gun. To accommodate this, the powder flow changes how much powder is being delivered to the gun, while the atomizing air changes how fast the powder is exiting the nozzle. This is the "Classic Mode" that the controllers come standard with – controlling the powder flow and atomizing air independently.

For the best transfer efficiency, low velocity and dense powder clouds are ideal. In Classic Mode, there can be a lot of trial and error to get the settings just right. The available automatic controllers incorporate Encore's "Smart Flow" pneumatic control capability – an easy, intuitive method of setting powder flow that takes transfer efficiency into account. When Smart Flow is activated, the spray pattern velocity is set first, followed by the powder output level, helping to achieve the desired powder cloud properties and a more consistent film thickness on the part.

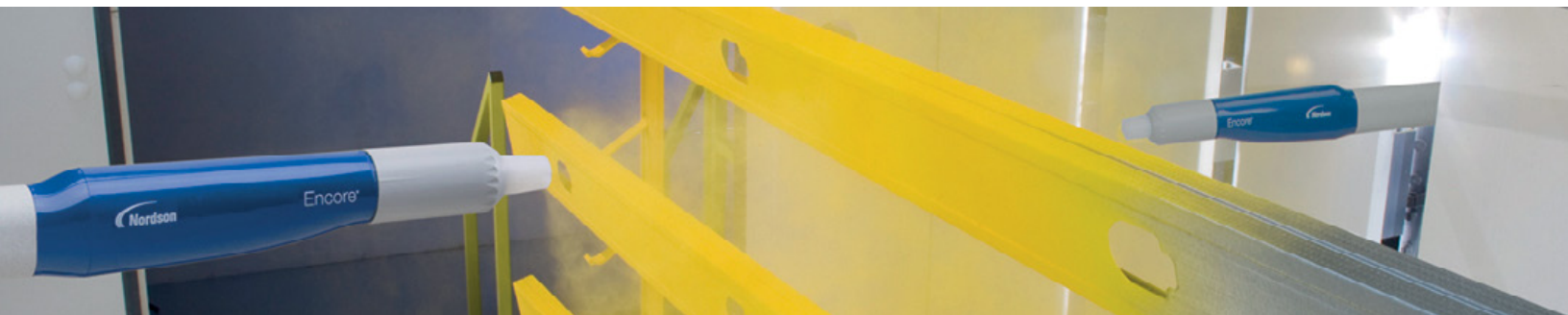
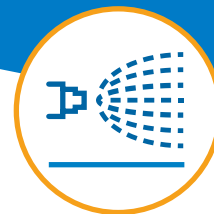

Tube and Bar Mount Options

The Encore automatic gun is available in both tube-mount and bar-mount configurations, to provide flexibility over a broad range of powder coating methods and applications.

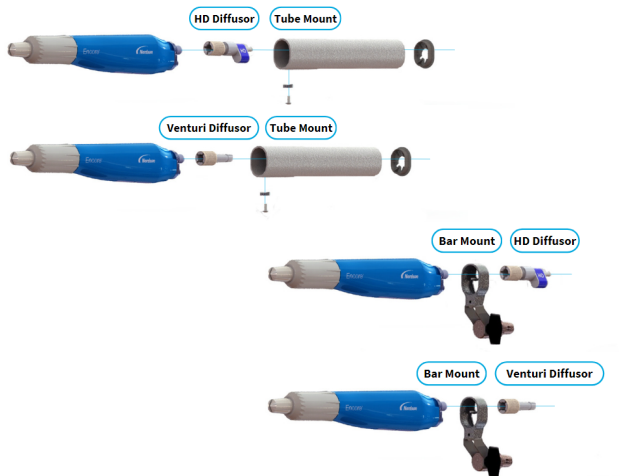

The Encore tube-mount gun is designed specifically for ultra-fast color-changes in mind. With smooth transitions and smooth geometry, the tube-mounts offer the best in cleanability. It is available in multiple standard lengths, to accommodate varying powder spray booth widths and part profiles.



The Encore bar-mount version provides a compact, lightweight option, ideal for use in robot applications or in multiple-gun powder coating systems that require mounting orientation and angle flexibility.

The gun's adjustable mounting bracket enables 180-degree pitch positioning capability for highly effective directional coating. "Lead and lag" gun positioning is also accommodated through bar-mounting options. This highly accurate, directional gun positioning capability helps achieve complete coverage no matter the part geometry being coated.

Easy Access Cleaning and Maintenance

The Encore automatic gun's aerodynamic shape and smooth, engineered-material external surfaces facilitate fast, easy powder blow-off during system color change.

The gun is easily disassembled for routine maintenance to check for wear on all powder-contact parts. The integral voltage multiplier is user replaceable.

Features and Benefits

- **Automatic Feedback Current control** delivers higher, more consistent, transfer efficiency.
- **Integral-power-supply designed for optimal (100 kV) voltage** for automatic applications.
- **Compact, lightweight** for ease of operation.
- **Superior Faraday-cage penetration and re-coating capability** to accommodate a wide range of coating requirements.
- **Powder Flow path incorporates specialty materials** designed for durability and longevity.
- **Easy access flow path retention and design** makes routine cleaning and maintenance fast and uncomplicated.
- **Encore Venturi or Encore HD pump technology compatibility** with the inclusion of the Encore HD Diffuser.
- **Tube mount and bar mount configurations** with bar mount adapter kit are available for added versatility.
- **End Mount diffuser engineered to** deliver consistent performance on every gun, no matter the extension length.
- **Optional ion collector** is available which, in select applications, can improve the smoothness and appearance of specialty powders.



Specifications

Dimensions:	H: 2.6 in (6.6 cm)
	W: 1.93 in (4.9 cm)
	L: 5' Tube Mount, 65.31 in (165.9 cm)
	L: 6' Tube Mount*, 77.12 in (195.9 cm)
Weights:	L: Bar Mount, 17.1 in (43.4 cm)
	5' Tube Mount: 4.45 lbs (2.02 kg)
	6' Tube Mount*: 5.23 lbs (2.37 kg)
	Bar Mount: 1.44 lbs (651 g)

* Limited by application requirements

© 2024 Nordson Corporation | All Rights Reserved | PWL-18-5631 | Issue 04/24

Nordson Industrial Coating Systems

100 Nordson Drive
Amherst, OH 44001
US

Phone: +1 (440) 985-4000
www.nordson.com/ics



/Nordson_Coating



/NordsonICS



/company/nordson-industrial-coating-systems

Find your local Nordson office:
www.nordson.com/icslocations

Performance by design

